

REMINGTON AMENDMENT NO. 2 TO DECLARATION OF PROTECTIVE  
COVENANTS, CONDITIONS AND RESTRICTIONS

A. On February 22, 1989, The Quadrant Corporation a Washington corporation as "Declarant" recorded with the King County Department of Records and Elections, King County Recording No. 8902220506, that certain Declaration of Protective Covenants, Conditions and Restrictions, Remington Division I ("Declaration"); and

B. On April 5, 1989, Declarant recorded with the King County Department of Records and Elections, King County Recording No. 8904051063, Amendment No. 1 to the Declaration; and

C. In accordance with Article 2 of the Declaration, Declarant is desirous of subjecting additional adjacent real property owned by Declarant and described as follows (see attached):

Lots 1-80, Remington, Division 2, according to the plat thereof recorded in Volume 152 of Plats, Pages 13 through 18, records of King County, Washington.

and shown on Exhibit A (legal description) and shown on Exhibit B (plat map), which are attached hereto and by this reference incorporated herein (Division 2) to the terms and provisions of this Declaration;

NOW, THEREFORE, as covenants running with the land, Declarant hereby declares and amends the Declaration as follows:

1. In accordance with Article 2, Section 3 of the Declaration, Division 2 shall be and shall constitute a part of the properties which is subject to and governed by this Declaration. All rights, liabilities, terms and provisions of this Declaration shall inure to the benefit of and be binding upon Division 2 and any and all lot owners thereof.

2. Except as amended herein, the Declaration shall remain in full force and effect.  
Dated this 5th of May, 1990.

THE QUADRANT CORPORATION, Declarant

By [Signature]

Its Vice President

RECORDED BY  
KING COUNTY  
MAY 11 3 21 PM '90

RECEIVED THIS DAY

#1502 A

STATE OF WASHINGTON)  
COUNTY OF KING ) SS.

RECD F 7.00  
REC FEE 2.00  
CRSHSL

\*\*\*\*9.00  
55

I CERTIFY that I know or have satisfactory evidence that Seip Helmen is the person who appeared before me, and said person acknowledged that he signed this instrument, on oath stated that he was authorized to execute the instrument and acknowledge it as the Vice President of THE QUADRANT CORPORATION to be the free and voluntary act of such party for the uses and purposes mentioned in this instrument.

DATED: May 6, 1990  
Barbara J. Henderson  
Signature  
Natany  
Title  
My Appointment Expires 6/30/90

MAY 11 1990 FILED BY CTI

Filed by Chicago Title Insurance Co.  
Ref. # W9945-6

9005111502

EXHIBIT "A"

THAT PORTION OF SECTION 5, TOWNSHIP 21 NORTH, RANGE 6 EAST, W.M., IN KING COUNTY, WASHINGTON, BEING MORE PARTICULARLY DESCRIBED AS FOLLOWS:

COMMENCING AT A STONE MONUMENT MARKING THE WEST QUARTER CORNER OF SAID SECTION 5;

THENCE ALONG THE WEST LINE OF THE SOUTHWEST QUARTER OF SAID SECTION S00°53'06"E 1543.90 FEET;

THENCE N89°06'54"E 30.00 FEET TO THE SOUTHWEST CORNER OF REMINGTON DIVISION I ACCORDING TO THE PLAT THEREOF RECORDED IN VOLUME 144 OF PLATS, PAGES 44-50, INCLUSIVE, RECORDS OF SAID COUNTY, AND THE TRUE POINT OF BEGINNING;

THENCE ALONG THE SOUTHERLY LINE OF SAID PLAT N58°35'18"E 2520.36 FEET TO THE BEGINNING OF A NON-TANGENT CURVE CONCAVE TO THE WEST HAVING A RADIUS OF 350.00 FEET (A RADIAL LINE THROUGH SAID BEGINNING BEARS S88°55'20"E);

THENCE NORTHERLY AND NORTHWESTERLY 150.84 FEET ALONG SAID CURVE THROUGH A CENTRAL ANGLE OF 24°41'32";

THENCE N23°36'52"W 9.57 FEET;

THENCE N58°35'18"E 60.56 FEET;

THENCE S23°36'52"E 17.79 FEET TO THE BEGINNING OF A CURVE CONCAVE TO THE WEST HAVING A RADIUS OF 410.00 FEET;

THENCE SOUTHEASTERLY AND SOUTHERLY 139.51 FEET ALONG SAID CURVE THROUGH A CENTRAL ANGLE OF 19°26'44" TO A RADIAL LINE OF SAID CURVE WHICH BEARS N85°52'52"E;

THENCE ALONG A NON-TANGENT LINE N58°35'18"E 373.19 FEET;

THENCE S00°38'16"W 1402.40 FEET;

THENCE N87°56'53"E 1245.22 FEET TO THE SOUTHEAST CORNER OF TRACT "H" OF SAID PLAT;

THENCE LEAVING SAID SOUTHERLY LINE S00°01'24"E 163.96 FEET;

THENCE N87°56'53"E 1247.07 FEET TO THE EAST LINE OF THE SOUTHEAST QUARTER OF SAID SECTION 5;

THENCE ALONG SAID EAST LINE S00°41'02"E 939.26 FEET TO A LINE PARALLEL WITH AND 50.00 FEET MEASURED AT RIGHT ANGLES, DISTANT NORTHERLY FROM THE SOUTH LINE OF SAID SOUTHEAST QUARTER;

THENCE ALONG SAID PARALLEL LINE S88°04'08"W 2517.92 FEET TO A LINE PARALLEL WITH AND 50.00 FEET, WHEN MEASURED AT RIGHT ANGLES, DISTANT NORTHERLY FROM THE SOUTH LINE OF THE SOUTHWEST QUARTER OF SAID SECTION.

THENCE ALONG SAID PARALLEL LINE S87°57'37"W 2483.78 FEET TO THE EAST MARGIN OF 196TH AVENUE SE;

THENCE ALONG SAID EAST MARGIN N00°53'06"W 1045.50 FEET TO THE TRUE POINT OF BEGINNING.

SUBJECT TO ELECTRICAL POWER TRANSMISSION LINE EASEMENT BY INSTRUMENT UNDER KING COUNTY RECORDING NO. 5923555;

SITUATE IN THE COUNTY OF KING, STATE OF WASHINGTON.

9005111502

MAY 11 1990

FILED BY CTI

EXHIBIT "P"

EXISTING  
DEVELOPMENT  
(REMINGTON DIVISION I)

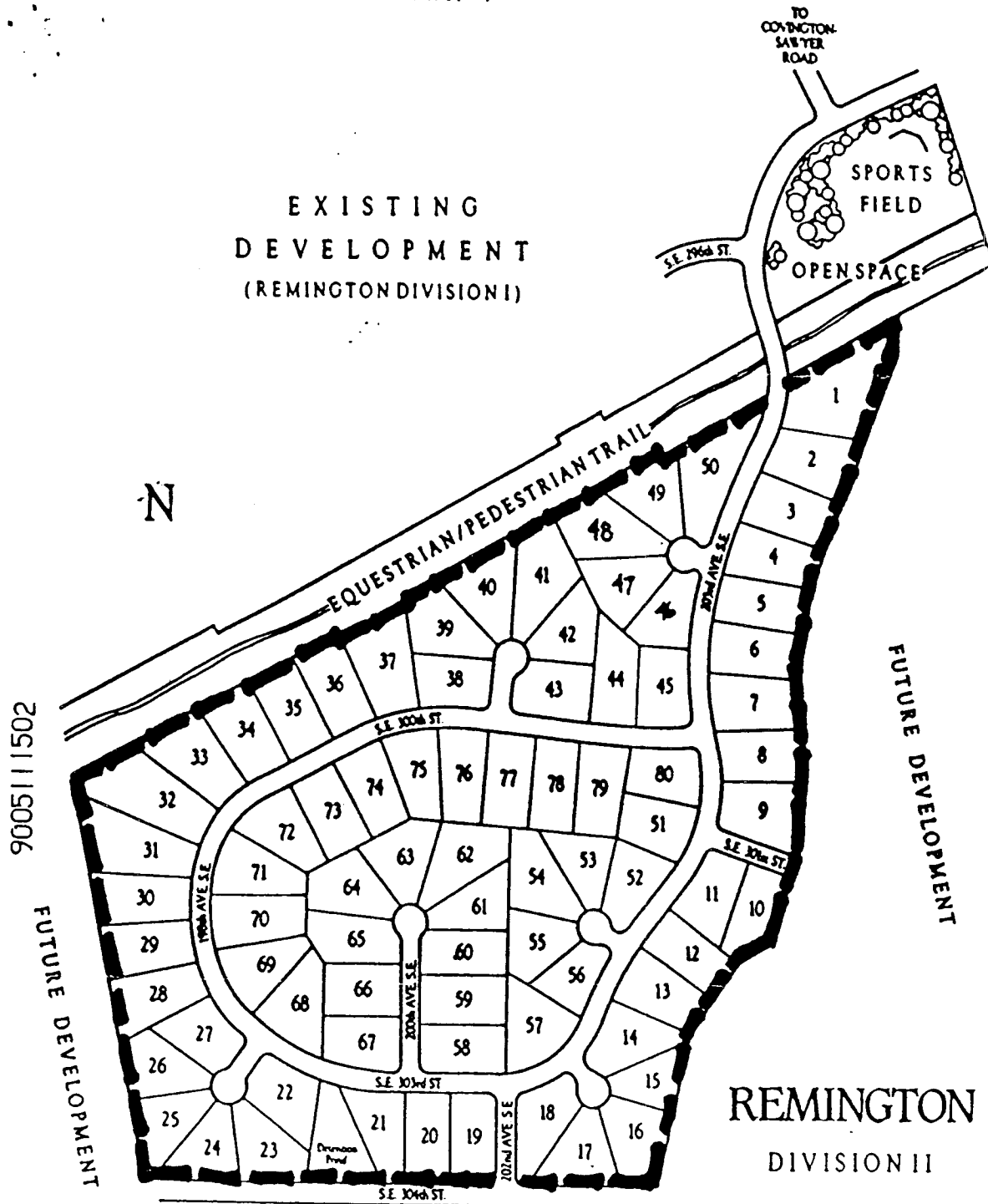

MAY 11 1990

FILED BY CTI